

For installation where the slope is 15-25 it is recommended that USG M7 molding be installed with the USG adjustable wall molding bracket

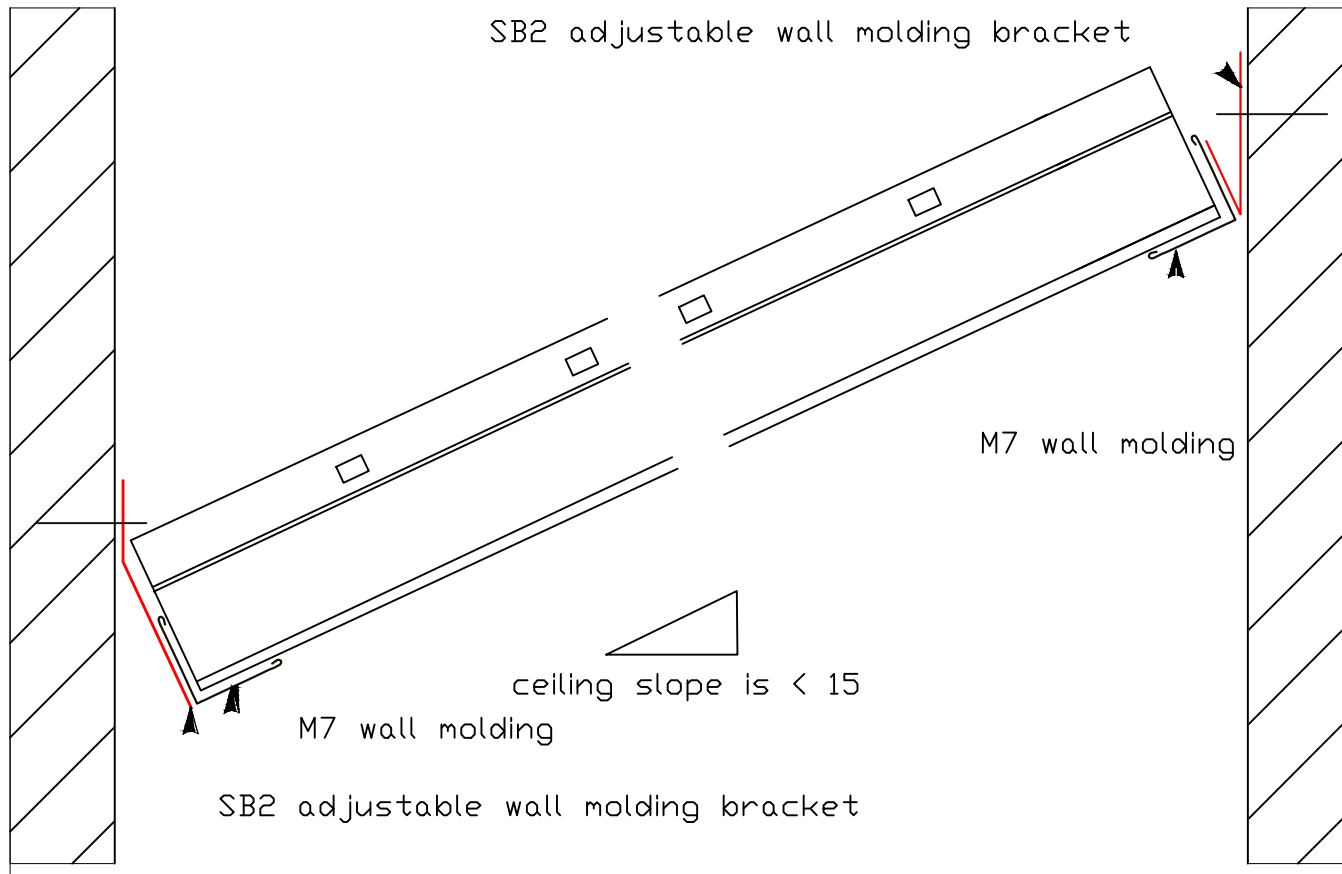

USG M7 Clip @ 15 – 25

SCALE: NTS

DATE:

DETAIL  
SHEET

UNITED STATES GYPSUM COMPANY

This Sesimic Detail must not be used without a complete evaluation by owner's design professional to verify the suitability of the design for a given structure.