

TAPE AND FINISH  
BEHIND CABINET

ONE OR TWO LAYERS OF  
DRYWALL AS REQUIRED  
FOR WALL CONSTRUCTION

STUDS SIZED  
AS REQUIRED  
FOR PIPING

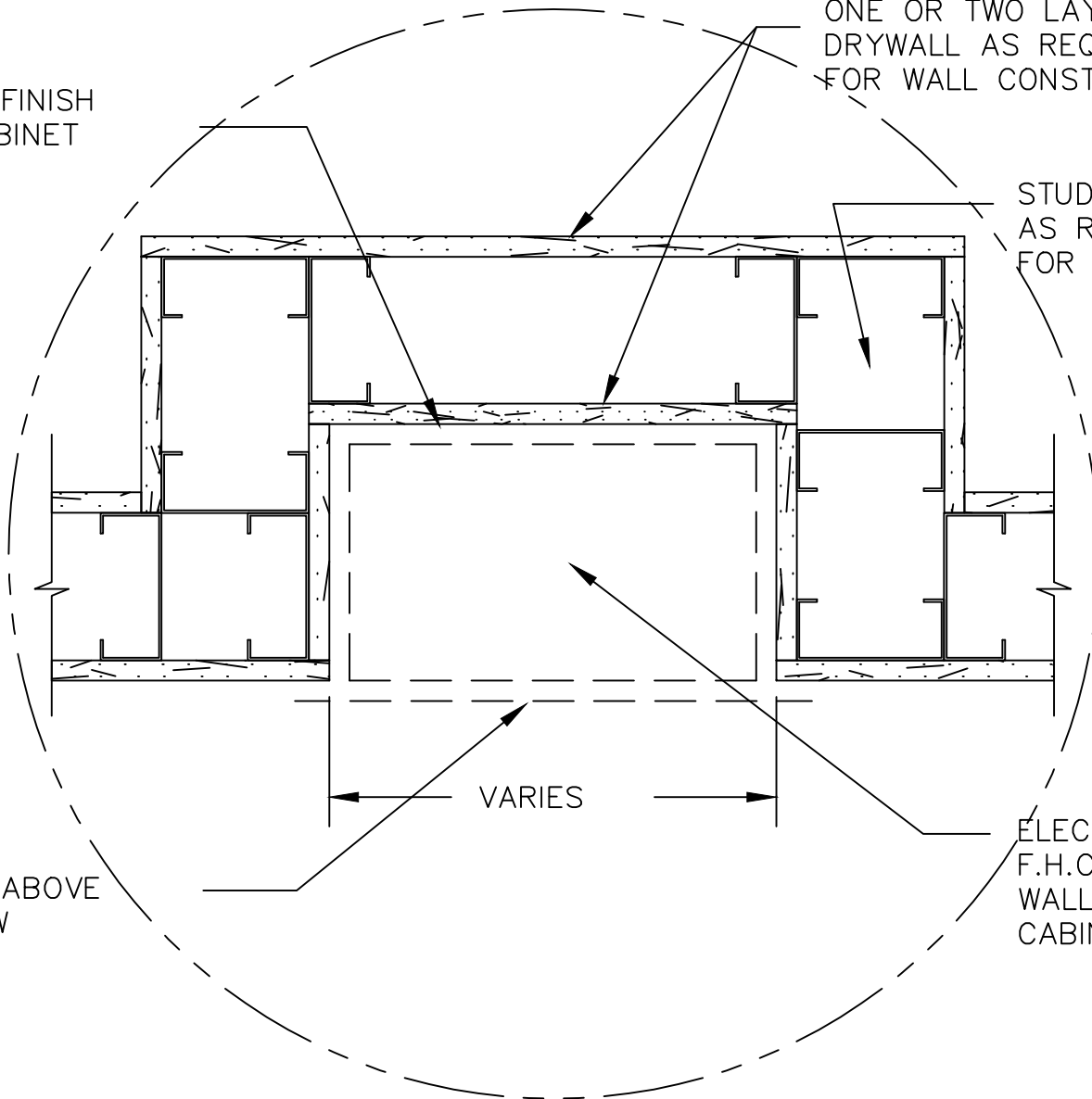

FUR WALL ABOVE  
AND BELOW

VARIES

ELECT. PANEL  
F.H.C. OR OTHER  
WALL MOUNTED  
CABINET

## RECESSED WALL CABINET

SCALE: 3"=1'-0"

DATE: 5/14/91

DETAIL  
SHEET

UNITED STATES GYPSUM COMPANY

This Gypsum Board Assembly detail must  
not be used without a complete evaluation by owner's design professional  
to verify the suitability of the design for a given structure.